



# SARIGÜLLER Limited

SARIGÜLLER MÜH. İNŞ. ve YAPI ELM. SAN. TİC. LTD. ŞTİ.  
EĞİTİM MAH. KASAP İSMAIL SOK. AVRASYA İŞ M. KAT:1 D:16 HASANPAŞA/İSTANBUL  
TEL: 0 216 337 43 10 - 0 216 337 43 11 FAX: 0 216 337 43 09

KONU/SUBJECT:

ISI YALITIMLI  
ÇATI SÜZGEÇİ

ROOF GULLY WITH  
THERMAL INSULATION

SAYFA NO:  
PAGE NO:

2

SCALE:  
ÖLÇEK:

1/5

RESİM NO:  
DWG. NO:

SA101105.DWG

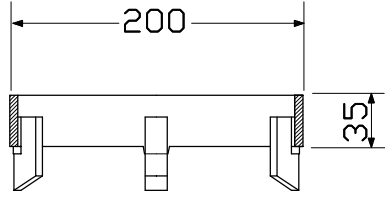
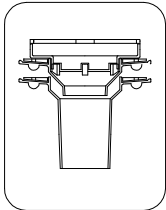
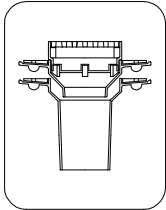
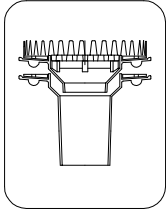
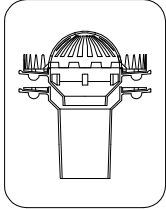
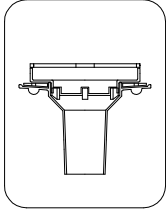
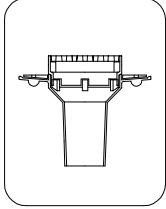
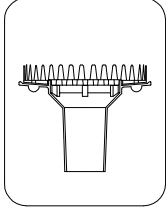
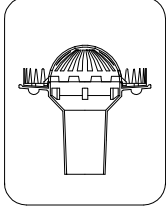

YÜKSELTME HALKASI  
CLAMPING RING

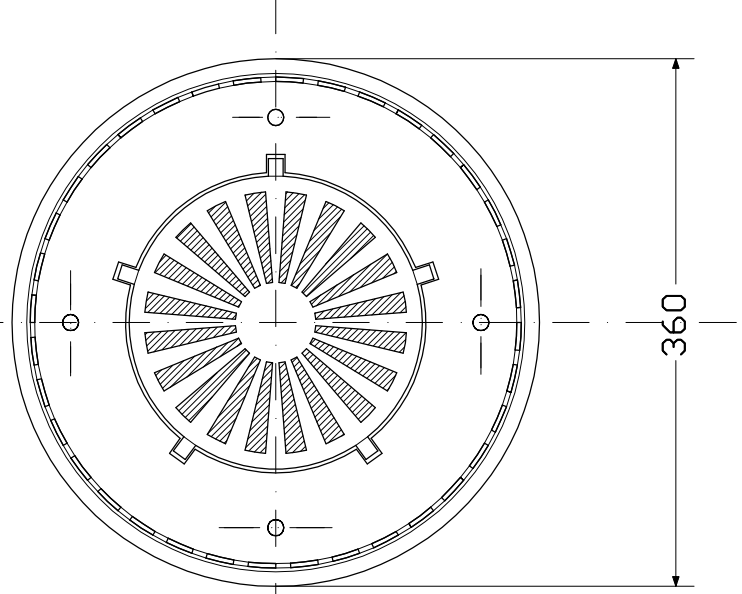

PLAN

ÇAKIL  
GRAVEL

ISI YALITIMI  
THERMAL INSULATION

SU YALITIMI  
WATER PROOFING

EĞİM BETONU  
INCLINED CONCRETE

B.A. DÖŞEME  
REINFORCED CONCRETE FLOORING

SIVA  
PLASTER

KÜRESEL İZGARA  
SPHERICAL GRID

KESİT/SECTION

KOD NO: CODE NO:	ÇAP DIAMETER	AĞIRLIK WEIGHT kg.	KESİT KALINLIĞI WALL THICKNESS mm.	SERVİS ALANI SERVICE AREA m <sup>2</sup>	MALZEME/ MATERIALS	
					ALT GÖVDE BOTTOM PART	ÜST İZGARA UPPER GRATING
SA101-70	ø70	17	5	50	PIK DÖKÜM CASTING	PIK DÖKÜM CASTING
SA102-100	ø100			150		
SA103-125	ø125	250				
SA104-150	ø150	400				
SA105-200	ø200	500				