



SARIGÜLLER Limited

SARIGÜLLER MÜH. İNŞ. ve YAPI ELM. SAN. TİC. LTD. ŞTİ.
EĞİTİM MAH. KASAP İSMAIL SOK. AVRASYA İŞ M. KAT:1 D:16 HASANPAŞA/İSTANBUL
TEL: 0 216 337 43 10 - 0 216 337 43 11 FAX: 0 216 337 43 09

KONU/SUBJECT:

KÖPRÜ GAYGUYLARI
BRIDGE DRAIN

SAYFA NO:
PAGE NO:

84

SCALE:
ÖLÇEK:

1/5

RESİM NO:
DWG. NO:

S810.DWG

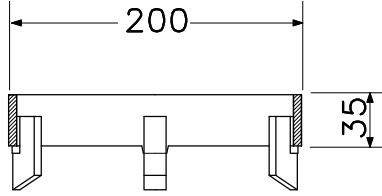
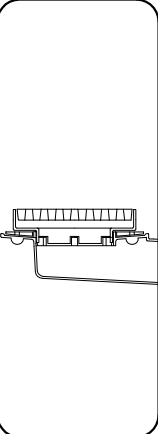
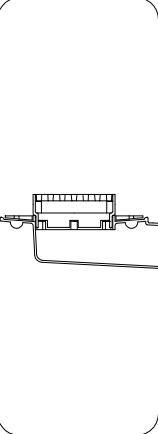
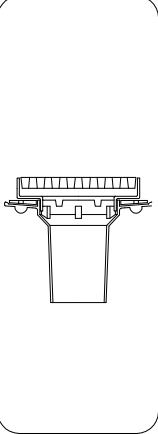
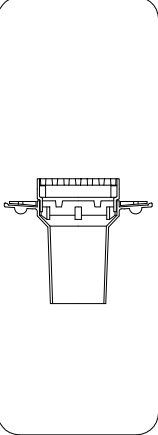

YÜKSELTME HALKASI
CLAMPING RING

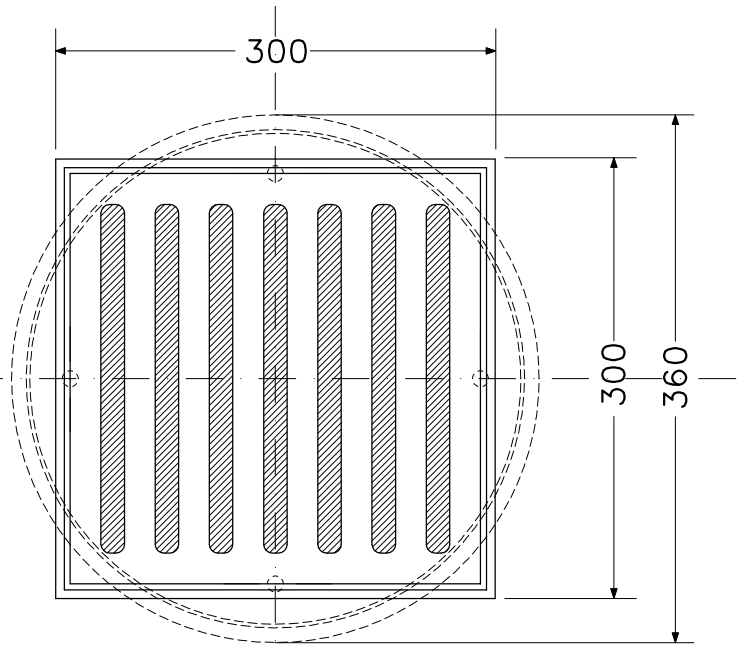

PLAN

YALITIM SIKMA HALKASI
INSULATING CLAMPING
COLLAR GRIBE

ASFALT KAPLAMA
ASPHALT CLADDING

SU YALITIMI
WATER PROOFING

TABLIYE BETONU
PLATFORM CONCRETE

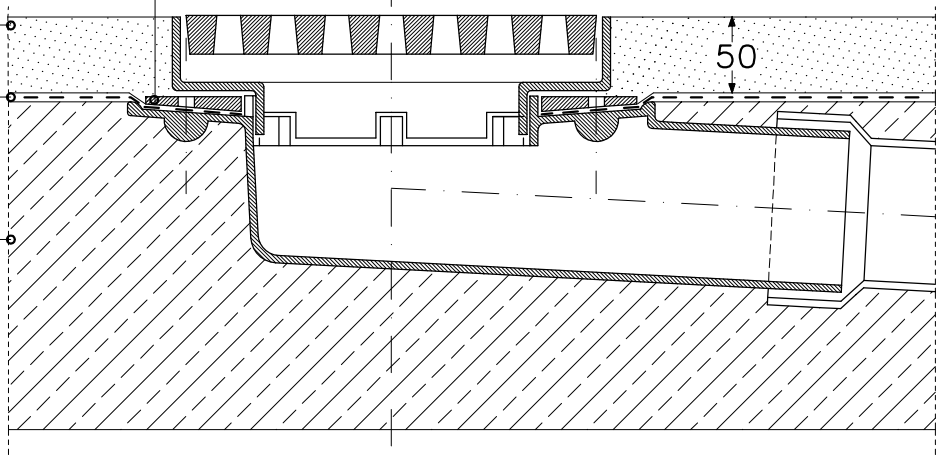

KESİT/SECTION

| KOD NO: CODE NO: | ÇAP DIAMETER | AĞIRLIK WEIGHT kg. | KESİT KALINLIĞI WALL THICKNESS mm. | SERVİS ALANI SERVICE AREA m ² | MALZEME/ MATERIALS | |
|---------------------|-----------------|--------------------------|--|--|--------------------------|-----------------------------|
| | | | | | ALT GÖVDE BOTTOM PART | ÜST İZGARA UPPER GRATING |
| S810-100 | ø100 | 34 | 5 | 150 | PİK DÖKÜM CASTING | PİK DÖKÜM CASTING |
| | | | | | | |